

Dealer Stamp:

Rotisserie Kit

Instructions

Models : 304415, 304417



PROQSMOKERS.COM

WARNING: Read and follow all instructions before use. Failure to do so may result in serious injury, or even death.

CAUTION: It is recommended that you do not exceed 3Kg (7 Lbs) when using your rotisserie. Heavier foods can cause the rotisserie motor to be overloaded.

1. Always attach the assembled Rotisserie to your grill first, then plug the Cord into an outlet. To disconnect, turn the Rotisserie "OFF" then remove the Plug from outlet.
2. Most rotisserie parts are hot during and after cooking. Use reasonable care around your grill and Rotisserie and wear insulated cooking mitts. Only manoeuvre the Rotisserie by its black handle.
3. To protect against electrical shock, do not immerse Electrical Cord, Plug or Motor in water or expose to rain. Protect electrical elements from burners, hot grill surfaces and grease.
4. Do not operate the Rotisserie if the cord or plug becomes damaged, or if the Rotisserie malfunctions or has been damaged in any manner.
5. Do not let children operate your grill or Rotisserie.
6. Do not let children play nearby, and do not leave unattended.
7. Unplug the Rotisserie from electrical outlet when not in use and before cleaning.
8. Allow to cool before adding or removing parts. When the Rotisserie is not in use, store it indoors in a dry place. Do not use Rotisserie for other than intended use.
9. The Rotisserie Motor is set for AC220-240V.
10. This Rotisserie is for outdoor use only.

Tools Required for Assembly: Adjustable wrench or pliers and a Phillips head screwdriver

Preassembly Instructions: Before assembling your Rotisserie, use the parts list below to check that all necessary parts have been included. Inspect parts for damage as you proceed. Do not assemble or operate your Rotisserie if it appears damaged. If you are missing parts or have questions during the assembly process, please contact your supplier.

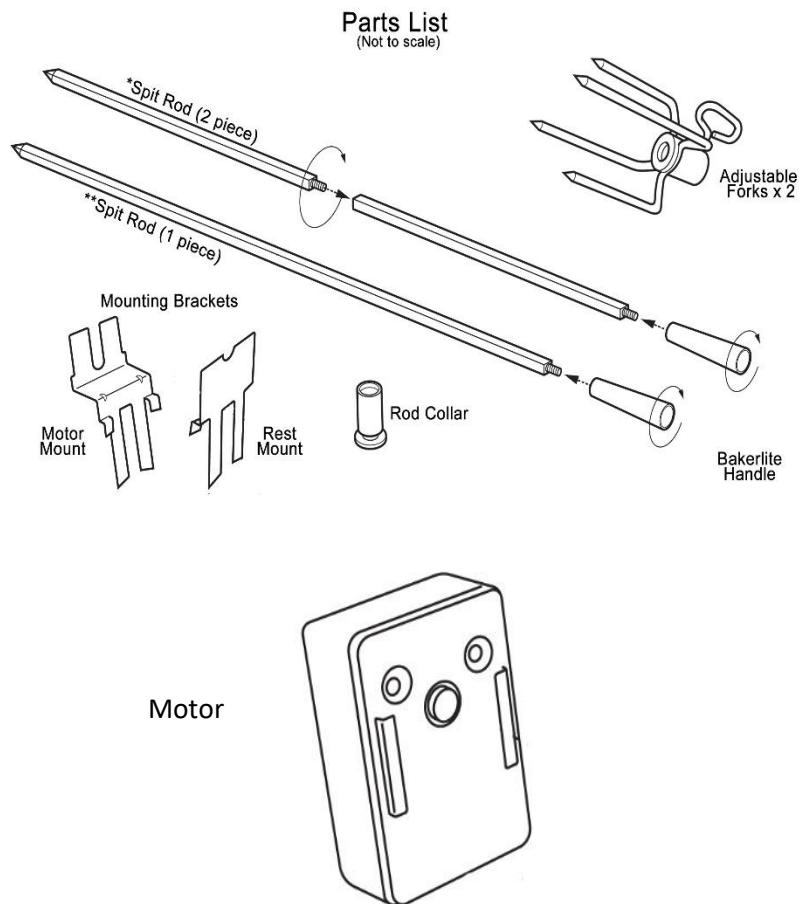

Assembly:

1. Loosen the bolts/nuts on the side handle brackets (1). In the case of the Excel 20 model remove the bolts/nuts.
2. Slide the Motor Bracket (3) and Rest Bracket (2) down behind the side handle brackets ensuring that the locator lugs rest onto the top edge of the stacker.
3. Tighten the bolts/nuts on the side handle brackets (1).
4. Assemble your food onto the spit rod, with the forks (be careful as the points are extremely sharp). Make sure that the food is evenly balanced and centrally located. Tighten the forks using the thumbscrews.
5. Slide the motor (4) onto the motor bracket (3).
6. Fully insert the spit tip (pointy end) of the spit rod into the motor.
7. Move the collar (6) making sure that the groove sits onto the rest bracket (2).
8. Power the motor on by using the switch located on the back of the housing.

NOTE: Occasionally you may have to re-tighten the fork and collar thumbscrews, as they can work loose.

9. Once the food is cooked, switch off the motor and remove the entire spit rod assembly (5) using the black (Bakelite) handle provided.
10. Loosen the fork closest to the pointed end, take care as all parts will be hot and remove your food.

Cleaning is simple, as all parts of the Spit Rod Assembly are made from high quality stainless steel. Use mild soapy water, or place in the dishwasher.

WARNING: At no time should the motor be exposed to or be submerged in water.

